

## Pulegge dentate profilo HTD

Le pulegge HTD hanno un disegno diverso da quello delle pulegge dentate tradizionali. Le gole assiali sono tagliate in modo che i denti della cinghia entrino ed escano con attrito trascurabile. Le pulegge HTD sono disponibili a mozzo pieno e per montaggio con bussola conica SER-SIT®.

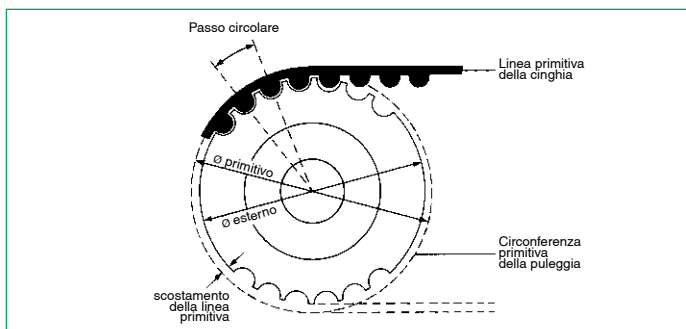

### Mozzo pieno

Materiale: alluminio/ghisa/acciaio

Passo:

- 3M
- 5M
- 8M
- 14M



### Per montaggio con bussola conica SER-SIT®

Materiale: ghisa/acciaio

Passo:

- 5M
- 8M
- 14M



### Pulegge speciali

Su richiesta è possibile costruire qualsiasi tipo di puleggia dentata anche su disegno del cliente.

Si consiglia l'esecuzione delle pulegge dentate in ghisa o in acciaio, quest'ultimo in particolare quando la velocità periferica è superiore a 33 m/s.

$$\text{velocità periferica in m/s} = \frac{\text{diametro puleggia in mm} \times \text{numero giri/min.}}{19100}$$

Per ragioni di peso le pulegge possono essere eseguite in metalli leggeri; in tal caso però bisogna prevedere una vita più breve perché la copertura in nylon della cinghia ha un effetto leggermente abrasivo. Per ovviare a questo inconveniente si consiglia l'ossidazione anodica a forte spessore sulla dentatura.

## TOLLERANZE

### Tolleranze dei diametri delle pulegge

Diametri esterni [mm]	Tolleranze [mm]
fino a 25,4	-0,00 +0,05
da 25,5 a 50,8	-0,00 +0,08
da 50,9 a 101,6	-0,00 +0,10
da 101,7 a 177,8	-0,00 +0,13
da 177,9 a 304,8	-0,00 +0,15
da 304,9 a 508,0	-0,00 +0,18
oltre 508,1	-0,00 +0,25

### Tolleranza di concentricità del foro rispetto al Ø esterno

Diametro esterno [mm]	Eccentricità totale letta sul comparatore [mm]
fino a 200	0,13
oltre 200	aggiungere 0,0005 per ogni mm oltre i 200

### Tolleranza di cilindricità

Larghezza puleggia	Tolleranza
per ogni 100 mm	0,1 mm senza superare la tolleranza sul diametro esterno

### Trattamenti protettivi

Tutte le pulegge sono trattate con un processo di trattamento superficiale che conferisce maggiore resistenza contro gli agenti ossidanti, preservando nel contempo il profilo esatto dei denti e le dimensioni funzionali delle pulegge.

### Pulegge flangiate

Le cinghie dentate, quando sono in funzione, hanno un leggero spostamento laterale. È quindi necessario, anche se la trasmissione è naturalmente allineata, usare almeno una puleggia flangiata, in modo di evitare che la cinghia possa uscire. Generalmente, per economia, la puleggia è la più piccola. In ogni caso, quando la distanza degli assi è maggiore di 8 volte il diametro della puleggia minore, oppure quando la trasmissione lavora sugli alberi disposti in qualsiasi altra posizione che non sia quella orizzontale, entrambe le pulegge dovranno essere flangiate.

### Note

Per motivi tecnici e produttivi in alcuni casi potrebbero essere utilizzati materiali diversi da quelli indicati nel catalogo. Per conferma del materiale effettivamente disponibile contattare il servizio clienti.

# Dimensioni delle pulegge dentate HTD a mozzo pieno passi 3M - 5M - 8M - 14M



### Esempio di codifica

PH 48 -8M 20

Puleggia dentata HTD a mozzo pieno

Numero denti della puleggia

Passo

Larghezza della cinghia in mm

### PH ... -3M09

3M

Codice	N° denti	Tipo	E [mm]	R [mm]	S [mm]	H [mm]	D [mm]	W [mm]	Y [mm]	Z [mm]	Flange	Materiale
PH 10 - 3M 09	10	2	13,0	9,55	8,79	5,0	12,0	10,2	17,5	7,3	con flange	alluminio
PH 12 - 3M 09	12	2	15,0	11,46	10,70	6,0	15,0	10,2	17,5	7,3		
PH 14 - 3M 09	14	2	16,0	13,37	12,61	7,0	18,0	10,2	17,5	7,3		
PH 15 - 3M 09	15	2	17,5	14,32	13,56	8,5	18,0	10,2	17,5	7,3		
PH 16 - 3M 09	16	1	17,5	15,28	14,52	10,0	-	12,8	20,6	7,8		
PH 18 - 3M 09	18	1	20,0	17,19	16,43	10,0	-	12,8	20,6	7,8		
PH 20 - 3M 09	20	1	23,0	19,10	18,34	13,0	-	12,8	20,6	7,8		
PH 21 - 3M 09	21	1	25,0	20,05	19,29	13,0	-	12,8	20,6	7,8		
PH 22 - 3M 09	22	1	25,0	21,01	20,25	13,0	-	12,8	20,6	7,8		
PH 24 - 3M 09	24	1	25,0	22,92	22,16	14,0	-	12,8	20,6	7,8		
PH 26 - 3M 09	26	1	28,0	24,83	24,07	16,0	-	12,8	20,6	7,8		
PH 28 - 3M 09	28	1	32,0	26,74	25,98	18,0	-	12,8	20,6	7,8		
PH 30 - 3M 09	30	1	32,0	28,65	27,89	20,0	-	12,8	20,6	7,8		
PH 32 - 3M 09	32	1	36,0	30,56	29,80	22,0	-	12,8	20,6	7,8		
PH 36 - 3M 09	36	1	39,0	34,38	33,62	26,0	-	13,4	22,2	8,8		
PH 40 - 3M 09	40	1	42,0	38,20	37,44	28,0	-	13,4	22,2	8,8		
PH 44 - 3M 09	44	1	48,0	42,02	41,26	33,0	-	13,4	22,2	8,8		
PH 48 - 3M 09	48	1A	-	45,84	45,08	33,0	-	13,4	22,2	8,8		
PH 60 - 3M 09	60	1A	-	57,30	56,54	33,0	-	13,4	22,2	8,8		
PH 72 - 3M 09	72	1A	-	68,75	67,99	33,0	-	13,4	22,2	8,8		

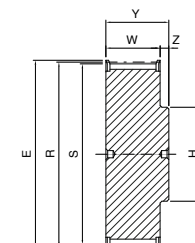

1

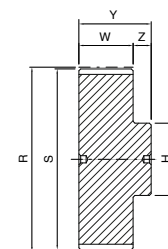

1A

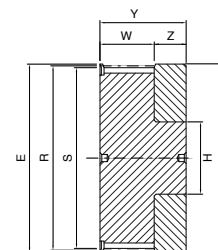

2

### PH ... -3M15

3M

Codice	N° denti	Tipo	E [mm]	R [mm]	S [mm]	H [mm]	D [mm]	W [mm]	Y [mm]	Z [mm]	Flange	Materiale
PH 10 - 3M 15	10	2	13,0	9,55	8,79	5,0	12,0	17,0	26,0	9,0	con flange	alluminio
PH 12 - 3M 15	12	2	15,0	11,46	10,70	6,0	15,0	17,0	26,0	9,0		
PH 14 - 3M 15	14	2	16,0	13,37	12,61	7,0	18,0	17,0	26,0	9,0		
PH 15 - 3M 15	15	2	17,5	14,32	13,56	8,5	18,0	17,0	26,0	9,0		
PH 16 - 3M 15	16	1	17,5	15,28	14,52	10,0	-	19,5	26,0	6,5		
PH 18 - 3M 15	18	1	20,0	17,19	16,43	10,0	-	19,5	26,0	6,5		
PH 20 - 3M 15	20	1	23,0	19,10	18,34	13,0	-	19,5	26,0	6,5		
PH 21 - 3M 15	21	1	25,0	20,05	19,29	13,0	-	19,5	26,0	6,5		
PH 22 - 3M 15	22	1	25,0	21,01	20,25	13,0	-	19,5	26,0	6,5		
PH 24 - 3M 15	24	1	25,0	22,92	22,16	14,0	-	19,5	26,0	6,5		
PH 26 - 3M 15	26	1	28,0	24,83	24,07	16,0	-	19,5	26,0	6,5		
PH 28 - 3M 15	28	1	32,0	26,74	25,98	18,0	-	19,5	26,0	6,5		
PH 30 - 3M 15	30	1	32,0	28,65	27,89	20,0	-	19,5	26,0	6,5		
PH 32 - 3M 15	32	1	36,0	30,56	29,80	22,0	-	19,5	26,0	6,5		
PH 36 - 3M 15	36	1	39,0	34,38	33,62	26,0	-	20,0	30,0	10,0		
PH 40 - 3M 15	40	1	42,0	38,20	37,44	28,0	-	20,0	30,0	10,0		
PH 44 - 3M 15	44	1	48,0	42,02	41,26	33,0	-	20,0	30,0	10,0		
PH 48 - 3M 15	48	1A	-	45,84	45,08	33,0	-	20,0	30,0	10,0		
PH 60 - 3M 15	60	1A	-	57,30	56,54	33,0	-	20,0	30,0	10,0		
PH 72 - 3M 15	72	1A	-	68,75	67,99	33,0	-	20,0	30,0	10,0		

## Dimensioni delle pulegge dentate HTD a mozzo pieno



### PH ... -5M09

5M

Codice	N° denti	Tipo	E [mm]	R [mm]	S [mm]	U [mm]	H [mm]	W [mm]	Y [mm]	Z [mm]	Flange	Materiale
PH 12 - 5M 09	12	1	23,0	19,10	17,96	-	12,0	14,5	20,0	5,5	con flange	acciaio
PH 14 - 5M 09	14	1	25,0	22,28	21,14	-	13,0	14,5	20,0	5,5		
PH 15 - 5M 09	15	1	28,0	23,87	22,73	-	16,0	14,5	20,0	5,5		
PH 16 - 5M 09	16	1	28,0	25,47	24,32	-	16,5	14,5	20,0	5,5		
PH 18 - 5M 09	18	1	32,0	28,65	27,51	-	20,0	14,5	20,0	5,5		
PH 20 - 5M 09	20	1	36,0	31,83	30,69	-	23,0	14,5	22,5	8,0		
PH 21 - 5M 09	21	1	38,0	33,42	32,28	-	24,0	14,5	22,5	8,0		
PH 22 - 5M 09	22	1	39,0	35,01	33,87	-	25,5	14,5	22,5	8,0		
PH 24 - 5M 09	24	1	42,0	38,19	37,06	-	27,0	14,5	22,5	8,0		
PH 26 - 5M 09	26	1	44,0	41,38	40,24	-	30,0	14,5	22,5	8,0		
PH 28 - 5M 09	28	1	48,0	44,56	43,42	-	30,5	14,5	22,5	8,0		
PH 30 - 5M 09	30	1	51,0	47,75	46,61	-	35,0	14,5	22,5	8,0		
PH 32 - 5M 09	32	1	54,0	50,93	49,79	-	38,0	14,5	22,5	8,0		
PH 36 - 5M 09	36	1	60,0	57,30	56,16	-	38,0	14,5	22,5	8,0		
PH 40 - 5M 09	40	1	71,0	63,66	62,52	-	38,0	14,5	22,5	8,0		
PH 44 - 5M 09	44	1A	-	70,03	68,89	-	38,0	14,5	25,5	11,0	senza flange	alluminio
PH 48 - 5M 09	48	1A	-	76,39	75,25	-	45,0	14,5	25,5	11,0		
PH 60 - 5M 09	60	1A	-	95,49	94,35	-	45,0	14,5	25,5	11,0		
PH 72 - 5M 09	72	3A	-	114,59	113,45	90	45,0	14,5	25,5	11,0		

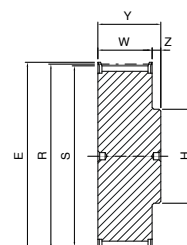

1

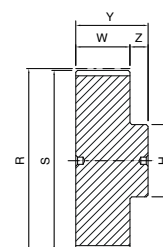

1A

### PH ... -5M15

5M

Codice	N° denti	Tipo	E [mm]	R [mm]	S [mm]	U [mm]	H [mm]	W [mm]	Y [mm]	Z [mm]	Flange	Materiale
PH 12 - 5M 15	12	1	23,0	19,10	17,96	-	12,0	20,5	26,0	5,5	con flange	acciaio
PH 14 - 5M 15	14	1	25,0	22,28	21,14	-	13,0	20,5	26,0	5,5		
PH 15 - 5M 15	15	1	28,0	23,87	22,73	-	16,0	20,5	26,0	5,5		
PH 16 - 5M 15	16	1	28,0	25,47	24,32	-	16,5	20,5	26,0	5,5		
PH 18 - 5M 15	18	1	32,0	28,65	27,51	-	20,0	20,5	26,0	5,5		
PH 20 - 5M 15	20	1	36,0	31,83	30,69	-	23,0	20,5	26,0	5,5		
PH 21 - 5M 15	21	1	38,0	33,42	32,28	-	24,0	20,5	26,0	5,5		
PH 22 - 5M 15	22	1	39,0	35,01	33,87	-	25,5	20,5	26,0	5,5		
PH 24 - 5M 15	24	1	42,0	38,19	37,06	-	27,0	20,5	28,0	7,5		
PH 26 - 5M 15	26	1	44,0	41,38	40,24	-	30,0	20,5	28,0	7,5		
PH 28 - 5M 15	28	1	48,0	44,56	43,42	-	30,5	20,5	28,0	7,5		
PH 30 - 5M 15	30	1	51,0	47,75	46,61	-	35,0	20,5	28,0	7,5		
PH 32 - 5M 15	32	1	54,0	50,93	49,79	-	38,0	20,5	28,0	7,5		
PH 36 - 5M 15	36	1	60,0	57,30	56,16	-	38,0	20,5	28,0	7,5		
PH 40 - 5M 15	40	1	71,0	63,66	62,52	-	38,0	20,5	28,0	7,5		
PH 44 - 5M 15	44	1A	-	70,03	68,89	-	38,0	20,5	30,0	9,5	senza flange	alluminio
PH 48 - 5M 15	48	1A	-	76,39	75,25	-	45,0	20,5	30,0	9,5		
PH 60 - 5M 15	60	1A	-	95,49	94,35	-	50,0	20,5	30,0	9,5		
PH 72 - 5M 15	72	3A	-	114,59	113,45	90	50,0	20,5	30,0	9,5		

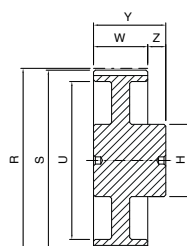

3A

PULEGGE DENTATE

# Dimensioni delle pulegge dentate HTD a mozzo pieno



## PH ... -5M25

5M

Codice	N° denti	Tipo	E [mm]	R [mm]	S [mm]	U [mm]	H [mm]	W [mm]	Y [mm]	Z [mm]	Flange	Materiale
PH 12 - 5M 25	12	1	23,0	19,10	17,96	-	12,0	30,0	36,0	6,0	con flange	acciaio
PH 14 - 5M 25	14	1	25,0	22,28	21,14	-	13,0	30,0	36,0	6,0		
PH 15 - 5M 25	15	1	28,0	23,87	22,73	-	16,0	30,0	36,0	6,0		
PH 16 - 5M 25	16	1	28,0	25,47	24,32	-	16,5	30,0	36,0	6,0		
PH 18 - 5M 25	18	1	32,0	28,65	27,51	-	20,0	30,0	36,0	6,0		
PH 20 - 5M 25	20	1	36,0	31,83	30,69	-	23,0	30,0	36,0	6,0		
PH 21 - 5M 25	21	1	38,0	33,42	32,28	-	24,0	30,0	38,0	8,0		
PH 22 - 5M 25	22	1	39,0	35,01	33,87	-	25,5	30,0	38,0	8,0		
PH 24 - 5M 25	24	1	42,0	38,19	37,06	-	27,0	30,0	38,0	8,0		
PH 26 - 5M 25	26	1	44,0	41,38	40,24	-	30,0	30,0	38,0	8,0		
PH 28 - 5M 25	28	1	48,0	44,56	43,42	-	30,5	30,0	38,0	8,0		
PH 30 - 5M 25	30	1	51,0	47,75	46,61	-	35,0	30,0	38,0	8,0		
PH 32 - 5M 25	32	1	54,0	50,93	49,79	-	38,0	30,0	38,0	8,0		
PH 36 - 5M 25	36	1	60,0	57,30	56,16	-	38,0	30,0	38,0	8,0		
PH 40 - 5M 25	40	1	71,0	63,66	62,52	-	38,0	30,0	38,0	8,0		
PH 44 - 5M 25	44	1A	-	70,03	68,89	-	38,0	30,0	40,0	10,0	senza flange	alluminio
PH 48 - 5M 25	48	1A	-	76,39	75,25	-	45,0	30,0	40,0	10,0		
PH 60 - 5M 25	60	1A	-	95,49	94,35	-	50,0	30,0	40,0	10,0		
PH 72 - 5M 25	72	3A	-	114,59	113,45	90	50,0	30,0	40,0	10,0		

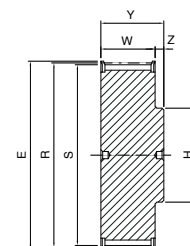

1

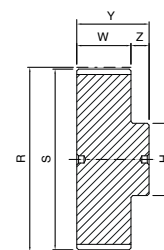

1A

## PH ... -8M20

8M

Codice	N° denti	Tipo	E [mm]	R [mm]	S [mm]	U [mm]	H [mm]	d [mm]	W [mm]	Y [mm]	Z [mm]	Flange	Materiale		
PH 18 - 8M 20	18	1	51,0	45,84	44,46	-	32,0	-	28	38	10	con flange	acciaio		
PH 20 - 8M 20	20	1	57,0	50,93	49,56	-	36,0	-	28	38	10				
PH 22 - 8M 20	22	1	60,0	56,02	54,65	-	43,0	-	28	38	10				
PH 24 - 8M 20	24	1	66,0	61,12	59,74	-	45,0	-	28	38	10				
PH 26 - 8M 20	26	1	70,0	66,21	64,84	-	48,0	-	28	38	10				
PH 28 - 8M 20	28	1	75,0	71,30	70,08	-	55,0	-	28	38	10				
PH 30 - 8M 20	30	1	83,0	76,39	75,13	-	60,0	-	28	38	10				
PH 32 - 8M 20	32	1	87,0	81,49	80,16	-	64,0	-	28	38	10				
PH 34 - 8M 20	34	1	91,0	86,58	85,21	-	70,0	-	28	38	10				
PH 36 - 8M 20	36	1	97,0	91,67	90,30	-	75,0	-	28	38	10				
PH 38 - 8M 20	38	1	102,0	96,77	95,39	-	80,0	-	28	38	10				
PH 40 - 8M 20	40	1	106,0	101,86	100,49	-	85,0	-	28	38	10				
PH 44 - 8M 20	44	1	120,0	112,05	110,67	-	96,0	-	28	38	10				
PH 48 - 8M 20	48	1	128,0	122,23	120,86	-	104,0	-	28	38	10				
PH 56 - 8M 20	56	5	150,0	142,60	141,23	117	80,0	12	28	38	10			senza flange	ghisa
PH 60 - 8M 20	60	5	158,0	152,79	151,42	127	80,0	12	28	38	10				
PH 64 - 8M 20	64	5	168,0	162,97	161,60	137	80,0	12	28	38	10				
PH 72 - 8M 20	72	5	192,0	183,35	181,97	158	80,0	12	28	38	10				
PH 80 - 8M 20	80	5A	-	203,72	202,35	179	90,0	12	28	38	10				
PH 84 - 8M 20	84	5A	-	213,90	212,53	190	90,0	12	28	38	10				
PH 90 - 8M 20	90	5A	-	229,18	227,81	204	90,0	12	28	38	10				
PH 112 - 8M 20	112	5B	-	285,21	283,83	260	90,0	18	28	38	10				
PH 144 - 8M 20	144	5B	-	366,69	365,32	342	90,0	20	28	38	10				
PH 168 - 8M 20	168	5B	-	427,80	426,44	403	100,0	20	28	38	10				
PH 192 - 8M 20	192	5B	-	488,92	487,54	465	100,0	20	28	38	10				

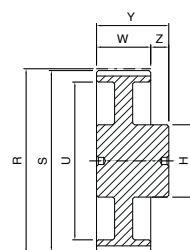

3A

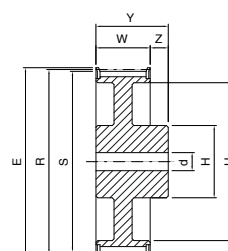

5

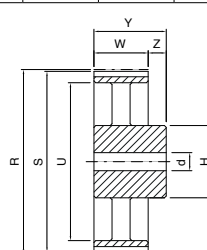

5B

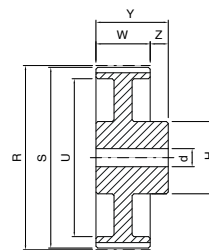

5A

# Dimensioni delle pulegge dentate HTD a mozzo pieno



## PH ... -8M30

8M

Codice	N° denti	Tipo	E [mm]	R [mm]	S [mm]	U [mm]	H [mm]	d [mm]	W [mm]	Y [mm]	Z [mm]	Flange	Materiale
PH 18 - 8M 30	18	1	51,0	45,84	44,46	-	32,0	-	38	48	10	con flange	acciaio
PH 20 - 8M 30	20	1	57,0	50,93	49,56	-	36,0	-	38	48	10		
PH 22 - 8M 30	22	1	60,0	56,02	54,65	-	43,0	-	38	48	10		
PH 24 - 8M 30	24	1	66,0	61,12	59,74	-	45,0	-	38	48	10		
PH 26 - 8M 30	26	1	70,0	66,21	64,84	-	48,0	-	38	48	10		
PH 28 - 8M 30	28	1	75,0	71,30	70,08	-	55,0	-	38	48	10		
PH 30 - 8M 30	30	1	83,0	76,39	75,13	-	60,0	-	38	48	10		
PH 32 - 8M 30	32	1	87,0	81,49	80,16	-	64,0	-	38	48	10		
PH 34 - 8M 30	34	1	91,0	86,58	85,21	-	70,0	-	38	48	10		
PH 36 - 8M 30	36	1	97,0	91,67	90,30	-	75,0	-	38	48	10		
PH 38 - 8M 30	38	1	102,0	96,77	95,39	-	75,0	-	38	48	10		
PH 40 - 8M 30	40	1	106,0	101,86	100,49	-	85,0	-	38	48	10		
PH 44 - 8M 30	44	1	120,0	112,05	110,67	-	96,0	-	38	48	10		
PH 48 - 8M 30	48	1	128,0	122,23	120,86	-	104,0	-	38	48	10		
PH 56 - 8M 30	56	5	150,0	142,60	141,23	117	90,0	12	38	48	10		
PH 60 - 8M 30	60	5	158,0	152,79	151,42	127	90,0	12	38	48	10		
PH 64 - 8M 30	64	5	168,0	162,97	161,60	137	90,0	12	38	48	10		
PH 72 - 8M 30	72	5	192,0	183,35	181,97	158	95,0	12	38	48	10		
PH 80 - 8M 30	80	5A	-	203,72	202,35	179	100,0	12	38	48	10		
PH 84 - 8M 30	84	5A	-	213,90	212,53	190	100,0	12	38	48	10		
PH 90 - 8M 30	90	5A	-	229,18	227,81	204	100,0	12	38	48	10		
PH 112 - 8M 30	112	5B	-	285,21	283,83	260	100,0	18	38	48	10		
PH 144 - 8M 30	144	5B	-	366,69	365,32	342	100,0	20	38	48	10		
PH 168 - 8M 30	168	5B	-	427,80	426,44	403	100,0	20	38	48	10		
PH 192 - 8M 30	192	5B	-	488,92	487,54	465	100,0	20	38	48	10		

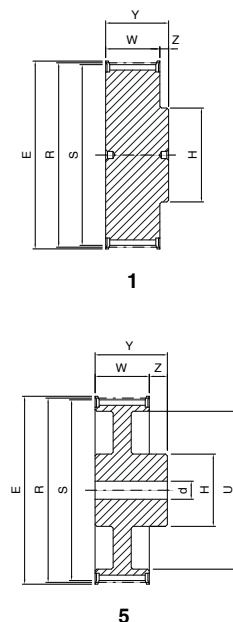

## PH ... -8M50

8M

Codice	N° denti	Tipo	E [mm]	R [mm]	S [mm]	U [mm]	H [mm]	d [mm]	W [mm]	Y [mm]	Z [mm]	Flange	Materiale
PH 18 - 8M 50	18	1	51,0	45,84	44,46	-	32,0	-	60	70	10	con flange	acciaio
PH 20 - 8M 50	20	1	57,0	50,93	49,56	-	36,0	-	60	70	10		
PH 22 - 8M 50	22	1	60,0	56,02	54,65	-	43,0	-	60	70	10		
PH 24 - 8M 50	24	1	66,0	61,12	59,74	-	49,0	-	60	70	10		
PH 26 - 8M 50	26	1	70,0	66,21	64,84	-	50,0	-	60	70	10		
PH 28 - 8M 50	28	1	75,0	71,30	70,08	-	55,0	-	60	70	10		
PH 30 - 8M 50	30	1	83,0	76,39	75,13	-	60,0	-	60	70	10		
PH 32 - 8M 50	32	1	87,0	81,49	80,16	-	64,0	-	60	70	10		
PH 34 - 8M 50	34	1	91,0	86,58	85,21	-	70,0	-	60	70	10		
PH 36 - 8M 50	36	1	97,0	91,67	90,30	-	75,0	-	60	70	10		
PH 38 - 8M 50	38	1	102,0	96,77	95,39	-	80,0	-	60	70	10		
PH 40 - 8M 50	40	1	106,0	101,86	100,49	-	85,0	-	60	70	10		
PH 44 - 8M 50	44	1	120,0	112,05	110,67	-	96,0	-	60	70	10		
PH 48 - 8M 50	48	1	128,0	122,23	120,86	-	104,0	-	60	70	10		
PH 56 - 8M 50	56	7	150,0	142,60	141,23	117	90,0	18	60	60	-		
PH 60 - 8M 50	60	7	158,0	152,79	151,42	127	100,0	18	60	60	-		
PH 64 - 8M 50	64	7	168,0	162,97	161,60	137	100,0	18	60	60	-		
PH 72 - 8M 50	72	7	192,0	183,35	181,97	158	100,0	18	60	60	-		
PH 80 - 8M 50	80	7A	-	203,72	202,35	179	110,0	18	60	60	-		
PH 84 - 8M 50	84	7B	-	213,90	212,53	190	110,0	18	60	60	-		
PH 90 - 8M 50	90	7B	-	229,18	227,81	204	110,0	18	60	60	-		
PH 112 - 8M 50	112	7B	-	285,21	283,83	260	110,0	18	60	60	-		
PH 144 - 8M 50	144	7B	-	366,69	365,32	342	110,0	20	60	60	-		
PH 168 - 8M 50	168	7B	-	427,80	426,44	403	120,0	20	60	60	-		
PH 192 - 8M 50	192	7B	-	488,92	487,54	465	130,0	20	60	60	-		

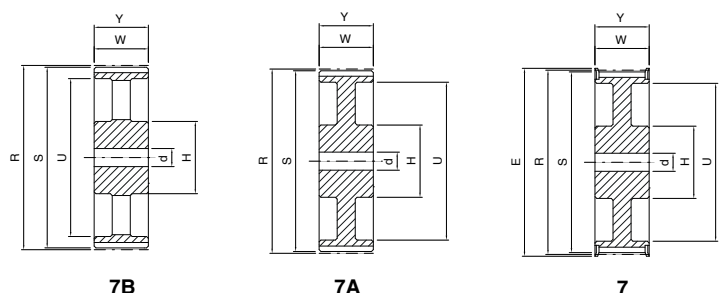
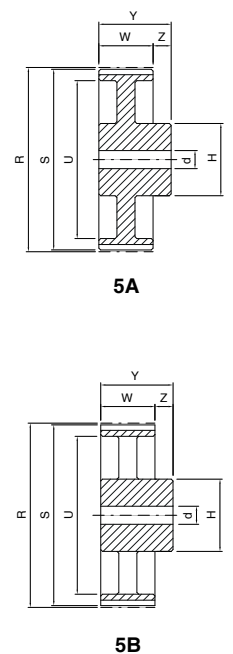

PULEGGE DENTATE

# Dimensioni delle pulegge dentate HTD a mozzo pieno



## PH ... -8M85

8M

Codice	N° denti	Tipo	E [mm]	R [mm]	S [mm]	U [mm]	H [mm]	d [mm]	W [mm]	Y [mm]	Z [mm]	Flange	Materiale
PH 22 - 8M 85	22	1	60,0	56,02	54,65	-	43,0	-	95	105	10	con flange	acciaio
PH 24 - 8M 85	24	1	66,0	61,12	59,74	-	45,0	-	95	105	10		
PH 26 - 8M 85	26	1	70,0	66,21	64,84	-	48,0	-	95	105	10		
PH 28 - 8M 85	28	1	75,0	71,30	70,08	-	55,0	-	95	105	10		
PH 30 - 8M 85	30	1	83,0	76,39	75,13	-	60,0	-	95	105	10		
PH 32 - 8M 85	32	1	87,0	81,49	80,16	-	64,0	-	95	105	10		
PH 34 - 8M 85	34	1	91,0	86,58	85,21	-	70,0	-	95	105	10		
PH 36 - 8M 85	36	1	97,0	91,67	90,30	-	75,0	-	95	105	10		
PH 38 - 8M 85	38	1	102,0	96,77	95,39	-	80,0	-	95	105	10		
PH 40 - 8M 85	40	1	106,0	101,86	100,49	-	85,0	-	95	105	10		
PH 44 - 8M 85	44	1	120,0	112,05	110,67	-	96,0	-	95	105	10		
PH 48 - 8M 85	48	1	128,0	122,23	120,86	-	100,0	-	95	105	10		
PH 56 - 8M 85	56	1	150,0	142,60	141,23	-	107,0	-	95	105	10		
PH 60 - 8M 85	60	1	158,0	152,79	151,42	-	132,0	-	95	105	10		
PH 64 - 8M 85	64	7	168,0	162,97	161,60	137	100,0	18	95	95	-		
PH 72 - 8M 85	72	7	192,0	183,35	181,97	158	110,0	18	95	95	-		
PH 80 - 8M 85	80	7A	-	203,72	202,35	179	110,0	20	95	95	-		
PH 84 - 8M 85	84	7A	-	213,90	212,53	190	110,0	20	95	95	-		
PH 90 - 8M 85	90	7B	-	229,18	227,81	204	110,0	20	95	95	-		
PH 112 - 8M 85	112	7B	-	285,21	283,83	260	110,0	24	95	95	-		
PH 144 - 8M 85	144	7B	-	366,69	365,32	342	120,0	24	95	95	-		
PH 168 - 8M 85	168	7B	-	427,80	426,44	403	120,0	24	95	95	-		
PH 192 - 8M 85	192	7B	-	488,92	487,54	465	130,0	24	95	95	-		

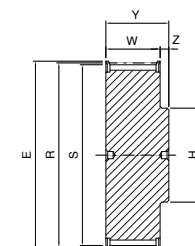

1

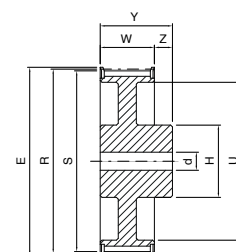

5

## PH ... -14M40

14M

Codice	N° denti	Tipo	E [mm]	R [mm]	S [mm]	U [mm]	H [mm]	d [mm]	W [mm]	Y [mm]	Z [mm]	Flange	Materiale
PH 28 - 14M 40	28	1	128,0	124,78	122,12	-	100,0	-	54	69	15	con flange	acciaio
PH 29 - 14M 40	29	1	138,0	129,23	126,57	-	107,0	-	54	69	15		
PH 30 - 14M 40	30	1	138,0	133,69	130,99	-	107,0	-	54	69	15		
PH 32 - 14M 40	32	1	154,0	142,60	139,88	-	114,0	-	54	69	15		
PH 34 - 14M 40	34	1	160,0	151,51	148,79	-	122,0	-	54	69	15		
PH 36 - 14M 40	36	1	168,0	160,43	157,68	-	128,0	-	54	69	15		
PH 38 - 14M 40	38	1	183,0	169,34	166,60	-	141,0	-	54	69	15		
PH 40 - 14M 40	40	1	198,0	178,25	175,49	-	148,0	-	54	69	15		
PH 44 - 14M 40	44	5	211,0	196,08	193,28	154	120,0	24	54	69	15		
PH 48 - 14M 40	48	5	226,0	213,90	211,11	172	135,0	24	54	69	15		
PH 56 - 14M 40	56	5	256,0	249,55	246,76	207	135,0	28	54	69	15		
PH 60 - 14M 40	60	5	275,0	267,38	264,59	225	135,0	28	54	69	15		
PH 64 - 14M 40	64	5	296,0	285,21	282,41	243	135,0	28	54	69	15		
PH 72 - 14M 40	72	5B	-	320,86	318,06	279	135,0	28	54	69	15		
PH 80 - 14M 40	80	5B	-	356,51	353,71	314	135,0	28	54	69	15		
PH 84 - 14M 40	84	5B	-	374,33	371,54	332	135,0	28	54	69	15		
PH 90 - 14M 40	90	5B	-	401,07	398,28	359	135,0	28	54	69	15		
PH 112 - 14M 40	112	5B	-	499,11	496,32	457	135,0	28	54	69	15		
PH 144 - 14M 40	144	5B	-	641,71	638,92	600	135,0	28	54	69	15		

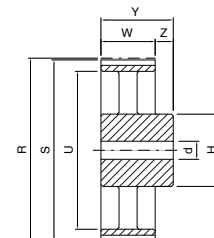

5B

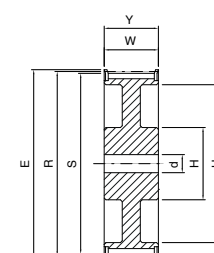

7

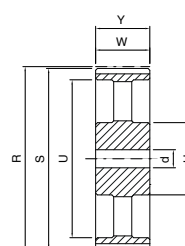

7B

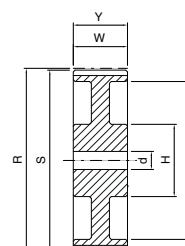

7A

# Dimensioni delle pulegge dentate HTD a mozzo pieno



## PH ... -14M55

14M

Codice	N° denti	Tipo	E [mm]	R [mm]	S [mm]	U [mm]	H [mm]	d [mm]	W [mm]	Y [mm]	Z [mm]	Flange	Materiale
PH 28 - 14M 55	28	1	128,0	124,78	122,12	-	100,0	-	70	85	15	con flange	acciaio
PH 29 - 14M 55	29	1	138,0	129,23	126,57	-	107,0	-	70	85	15		
PH 30 - 14M 55	30	1	138,0	133,69	130,99	-	107,0	-	70	85	15		
PH 32 - 14M 55	32	1	154,0	142,60	139,88	-	114,0	-	70	85	15		
PH 34 - 14M 55	34	1	160,0	151,51	148,79	-	122,0	-	70	85	15		
PH 36 - 14M 55	36	1	168,0	160,43	157,68	-	128,0	-	70	85	15		
PH 38 - 14M 55	38	1	183,0	169,34	166,60	-	141,0	-	70	85	15		
PH 40 - 14M 55	40	1	198,0	178,25	175,49	-	148,0	-	70	85	15		
PH 44 - 14M 55	44	5	211,0	196,08	193,28	154	120,0	24	70	85	15		
PH 48 - 14M 55	48	7	226,0	213,90	211,11	172	135,0	24	70	70	-		
PH 56 - 14M 55	56	7	256,0	249,55	246,76	207	135,0	28	70	70	-		
PH 60 - 14M 55	60	7	275,0	267,38	264,59	225	135,0	28	70	70	-		
PH 64 - 14M 55	64	7	296,0	285,21	282,41	243	135,0	28	70	70	-		
PH 72 - 14M 55	72	7B	-	320,86	318,06	279	135,0	28	70	70	-		
PH 80 - 14M 55	80	7B	-	356,51	353,71	314	135,0	28	70	70	-		
PH 84 - 14M 55	84	7B	-	374,33	371,54	332	135,0	28	70	70	-		
PH 90 - 14M 55	90	7B	-	401,07	398,28	359	135,0	28	70	70	-		
PH 112 - 14M 55	112	7B	-	499,11	496,32	457	135,0	28	70	70	-		
PH 144 - 14M 55	144	7B	-	641,71	638,92	600	135,0	28	70	70	-		

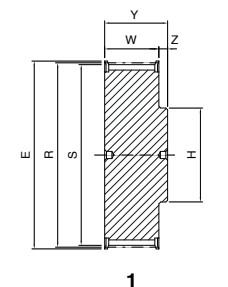

1

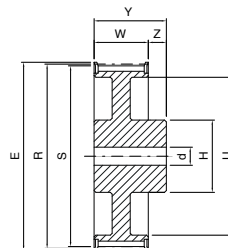

5

## PH ... -14M85

14M

Codice	N° denti	Tipo	E [mm]	R [mm]	S [mm]	U [mm]	H [mm]	d [mm]	W [mm]	Y [mm]	Z [mm]	Flange	Materiale
PH 28 - 14M 85	28	1	128,0	124,78	122,12	-	100,0	-	102	117	15	con flange	acciaio
PH 29 - 14M 85	29	1	138,0	129,23	126,57	-	107,0	-	102	117	15		
PH 30 - 14M 85	30	1	138,0	133,69	130,99	-	107,0	-	102	117	15		
PH 32 - 14M 85	32	1	154,0	142,60	139,88	-	114,0	-	102	117	15		
PH 34 - 14M 85	34	1	160,0	151,51	148,79	-	122,0	-	102	117	15		
PH 36 - 14M 85	36	1	168,0	160,43	157,68	-	128,0	-	102	117	15		
PH 38 - 14M 85	38	1	183,0	169,34	166,60	-	141,0	-	102	117	15		
PH 40 - 14M 85	40	1	198,0	178,25	175,49	-	148,0	-	102	117	15		
PH 44 - 14M 85	44	1	211,0	196,08	193,28	-	169,0	-	102	117	15		
PH 48 - 14M 85	48	1	226,0	213,90	211,11	-	186,0	-	102	117	15		
PH 56 - 14M 85	56	7	256,0	249,55	246,76	207	150,0	32	102	102	-		
PH 60 - 14M 85	60	7	275,0	267,38	264,59	225	150,0	32	102	102	-		
PH 64 - 14M 85	64	7	296,0	285,21	282,41	243	150,0	32	102	102	-		
PH 72 - 14M 85	72	7B	-	320,86	318,06	279	150,0	32	102	102	-		
PH 80 - 14M 85	80	7B	-	356,51	353,71	314	150,0	32	102	102	-		
PH 84 - 14M 85	84	7B	-	374,33	371,54	332	150,0	32	102	102	-		
PH 90 - 14M 85	90	7B	-	401,07	398,28	359	150,0	32	102	102	-		
PH 112 - 14M 85	112	7B	-	499,11	496,32	457	150,0	32	102	102	-		
PH 144 - 14M 85	144	7B	-	641,71	638,92	600	150,0	32	102	102	-		

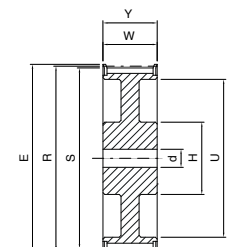

7

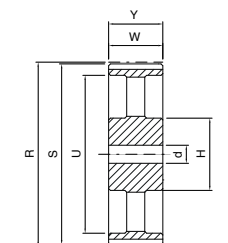

7B

PULEGGE DENTATE

# Dimensioni delle pulegge dentate HTD a mozzo pieno



## PH ... -14M115

14M

Codice	N° denti	Tipo	E [mm]	R [mm]	S [mm]	U [mm]	H [mm]	d [mm]	W [mm]	Y [mm]	Z [mm]	Flange	Materiale
PH 28 - 14M 115	28	1	128,0	124,78	122,12	-	100,0	-	133	148	15	con flange	acciaio
PH 29 - 14M 115	29	1	138,0	129,23	126,57	-	107,0	-	133	148	15		
PH 30 - 14M 115	30	1	138,0	133,69	130,99	-	107,0	-	133	148	15		
PH 32 - 14M 115	32	1	154,0	142,60	139,88	-	114,0	-	133	148	15		
PH 34 - 14M 115	34	1	160,0	151,51	148,79	-	122,0	-	133	148	15		
PH 36 - 14M 115	36	1	168,0	160,43	157,68	-	128,0	-	133	148	15		
PH 38 - 14M 115	38	1	183,0	169,34	166,60	-	141,0	-	133	148	15		
PH 40 - 14M 115	40	1	198,0	178,25	175,49	-	148,0	-	133	148	15		
PH 44 - 14M 115	44	1	211,0	196,08	193,28	-	169,0	-	133	148	15		
PH 48 - 14M 115	48	1	226,0	213,90	211,11	-	186,0	-	133	148	15		
PH 56 - 14M 115	56	5	256,0	249,55	246,76	207	150,0	32	133	148	15		
PH 60 - 14M 115	60	7	290,0	267,38	264,59	225	150,0	32	133	133	-		
PH 64 - 14M 115	64	7	296,0	285,21	282,41	243	150,0	32	133	133	-		
PH 72 - 14M 115	72	7B	-	320,86	318,06	279	150,0	32	133	133	-		
PH 80 - 14M 115	80	7B	-	356,51	353,71	314	150,0	32	133	133	-		
PH 84 - 14M 115	84	7B	-	374,33	371,54	332	150,0	32	133	133	-		
PH 90 - 14M 115	90	7B	-	401,07	398,28	359	150,0	32	133	133	-		
PH 112 - 14M 115	112	7B	-	499,11	496,32	457	150,0	32	133	133	-		
PH 144 - 14M 115	144	7B	-	641,71	638,92	600	150,0	32	133	133	-		

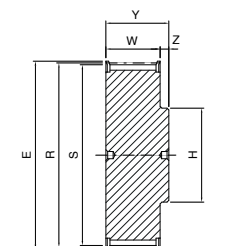

1

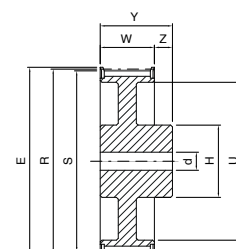

5

## PH ... -14M170

14M

Codice	N° denti	Tipo	E [mm]	R [mm]	S [mm]	U [mm]	H [mm]	d [mm]	W [mm]	Y [mm]	Z [mm]	Flange	Materiale
PH 28 - 14M 170	28	1	128,0	124,78	122,12	-	100,0	-	187	202	15	con flange	acciaio
PH 29 - 14M 170	29	1	138,0	129,23	126,57	-	107,0	-	187	202	15		
PH 30 - 14M 170	30	1	138,0	133,69	130,99	-	107,0	-	187	202	15		
PH 32 - 14M 170	32	1	154,0	142,60	139,88	-	114,0	-	187	202	15		
PH 34 - 14M 170	34	1	160,0	151,51	148,79	-	122,0	-	187	202	15		
PH 36 - 14M 170	36	1	168,0	160,43	157,68	-	128,0	-	187	202	15		
PH 38 - 14M 170	38	1	183,0	169,34	166,60	-	141,0	-	187	202	15		
PH 40 - 14M 170	40	1	198,0	178,25	175,49	-	148,0	-	187	202	15		
PH 44 - 14M 170	44	1	211,0	196,08	193,28	-	169,0	-	187	202	15		
PH 48 - 14M 170	48	1	226,0	213,90	211,11	-	186,0	-	187	202	15		
PH 56 - 14M 170	56	5	256,0	249,55	246,76	207	160,0	32	187	202	15		
PH 60 - 14M 170	60	5	290,0	267,38	264,59	225	160,0	32	187	202	15		
PH 64 - 14M 170	64	5	296,0	285,21	282,41	243	180,0	32	187	202	15		
PH 72 - 14M 170	72	7A	-	320,86	318,06	279	180,0	32	187	187	-		
PH 80 - 14M 170	80	7A	-	356,51	353,71	314	180,0	32	187	187	-		
PH 84 - 14M 170	84	7B	-	374,33	371,54	332	180,0	32	187	187	-		
PH 90 - 14M 170	90	7B	-	401,07	398,28	359	180,0	32	187	187	-		
PH 112 - 14M 170	112	7B	-	499,11	496,32	456	200,0	32	187	187	-		
PH 144 - 14M 170	144	7B	-	641,71	638,92	600	220,0	32	187	187	-		

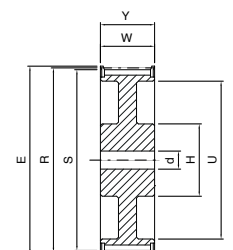

7

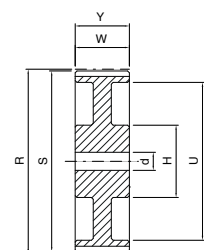

7A

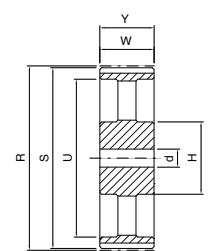

7B

# Dimensioni delle pulegge dentate HTD per montaggio con bussola conica SER-SIT® passi 5M - 8M - 14M



### Esempio di codifica

**PBH 32 -8M 20**

Puleggia HTD per bussola conica	
Numero di denti della puleggia	
Passo	
Larghezza della cinghia in mm	

### PBH ... -5M15

Codice	N° denti	Tipo	Bussola conica SER-SIT®	E [mm]	R [mm]	S [mm]	U [mm]	H [mm]	W [mm]	Y [mm]	Z [mm]	Flange	Materiale
PBH 34 - 5M 15	34	6	1008	57,0	54,11	52,97	-	-	22	22	-	con flange	acciaio
PBH 36 - 5M 15	36	6	1108	60,0	57,3	56,16	-	-	22	22	-		
PBH 38 - 5M 15	38	6	1108	66,5	60,48	59,34	-	-	22	22	-		
PBH 40 - 5M 15	40	6	1108	71,0	63,66	62,52	-	-	22	22	-		
PBH 44 - 5M 15	44	6	1108	75,0	70,03	68,89	-	-	22	22	-		
PBH 48 - 5M 15	48	2	1210	83,0	76,39	75,25	-	62,0	20,5	25	4,5		
PBH 56 - 5M 15	56	2	1210	93,0	89,13	87,99	-	70,0	20,5	25	4,5		
PBH 64 - 5M 15	64	2	1210	106,0	101,86	100,72	-	80,0	20,5	25	4,5		
PBH 72 - 5M 15	72	2	1610	119,0	114,59	113,45	-	92,0	20,5	25	4,5		
PBH 80 - 5M 15	80	2	1610	135,0	127,32	126,18	-	92,0	20,5	25	4,5		
PBH 90 - 5M 15	90	11A	1610	-	143,24	142,10	122	92,0	20,5	25	4,5		
PBH 112 - 5M 15	112	11A	1610	-	178,25	177,11	157	110,0	20,5	25	4,5		
PBH 136 - 5M 15	136	11A	2012	-	216,45	215,31	195	110,0	20,5	32	5,8		
PBH 150 - 5M 15	150	11A	2012	-	238,73	237,59	217	110,0	20,5	32	5,8		

**5M**

**2**

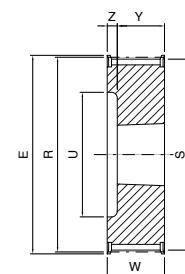
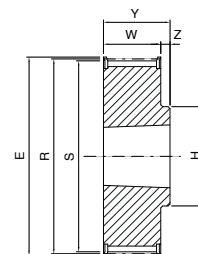

**4**

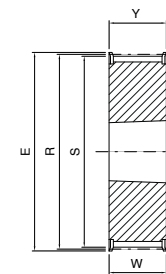

**6**

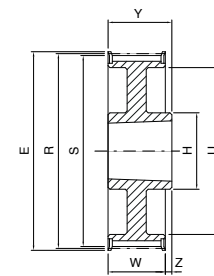

**9**

### PBH ... -8M20

Codice	N° denti	Tipo	Bussola conica SER-SIT®	E [mm]	R [mm]	S [mm]	U [mm]	H [mm]	W [mm]	Y [mm]	Z [mm]	Flange	Materiale
PBH 22 - 8M 20	22	4	1008	60,0	56,02	54,65	38	-	28	22	6	con flange	acciaio
PBH 24 - 8M 20	24	4	1108	66,0	61,12	59,74	42	-	28	22	6		
PBH 26 - 8M 20	26	4	1108	70,0	66,21	64,84	45	-	28	22	6		
PBH 28 - 8M 20	28	4	1108	75,0	71,30	70,08	52	-	28	22	6		
PBH 30 - 8M 20	30	4	1108	83,0	76,39	75,13	56	-	28	22	6		
PBH 32 - 8M 20	32	4	1610	87,0	81,49	80,16	65	-	28	25	3		
PBH 34 - 8M 20	34	4	1610	91,0	86,58	85,21	66	-	28	25	3		
PBH 36 - 8M 20	36	4	1610	97,0	91,67	90,30	68	-	28	25	3		
PBH 38 - 8M 20	38	4	1610	102,0	96,77	95,39	76	-	28	25	3		
PBH 40 - 8M 20	40	4	1610	106,0	101,86	100,49	80	-	28	25	3		
PBH 44 - 8M 20	44	2	2012	120,0	112,05	110,67	-	93,0	28	32	4		
PBH 48 - 8M 20	48	2	2012	128,0	122,23	120,86	-	100,0	28	32	4		
PBH 56 - 8M 20	56	2	2012	150,0	142,60	141,23	-	110,0	28	32	4		
PBH 64 - 8M 20	64	9	2012	168,0	162,97	161,60	140	110,0	28	32	4		
PBH 72 - 8M 20	72	9	2012	192,0	183,35	181,97	158	110,0	28	32	4		
PBH 80 - 8M 20	80	9A	2012	-	203,74	202,35	178	110,0	28	32	4		
PBH 90 - 8M 20	90	9B	2012	-	229,18	227,81	204	110,0	28	32	4		

**8M**

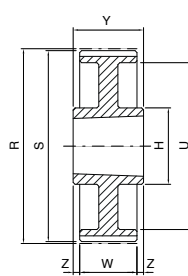

**11A**

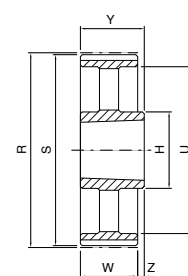

**9B**

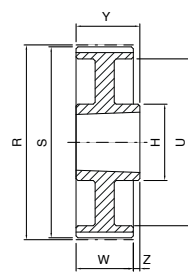

**9A**

PULEGGE DENTATE

# Dimensioni delle pulegge dentate HTD per montaggio con bussola conica SER-SIT®



## PBH ... -8M30

8M

Codice	N° denti	Tipo	Bussola conica SER-SIT®	E [mm]	R [mm]	S [mm]	U [mm]	H [mm]	W [mm]	Y [mm]	Z [mm]	Flange	Materiale
PBH 22 - 8M 30	22	4	1008	60,0	56,02	54,65	38	-	38	22	16	con flange	acciaio
PBH 24 - 8M 30	24	4	1108	66,0	61,12	59,74	42	-	38	22	16		
PBH 26 - 8M 30	26	4	1108	70,0	66,21	64,84	45	-	38	22	16		
PBH 28 - 8M 30	28	4	1108	75,0	71,30	70,08	52	-	38	22	16		
PBH 30 - 8M 30	30	6	1615	83,0	76,39	75,13	-	-	38	38	-		
PBH 32 - 8M 30	32	6	1615	87,0	81,49	80,16	-	-	38	38	-		
PBH 34 - 8M 30	34	6	1615	91,0	86,58	85,21	-	-	38	38	-		
PBH 36 - 8M 30	36	6	1615	97,0	91,67	90,30	-	-	38	38	-		
PBH 38 - 8M 30	38	6	1615	102,0	96,77	95,39	-	-	38	38	-		
PBH 40 - 8M 30	40	6	1615	106,0	101,86	100,49	-	-	38	38	-		
PBH 44 - 8M 30	44	5	2012	120,0	112,05	110,67	90	-	38	32	3		
PBH 48 - 8M 30	48	5	2012	128,0	122,23	120,86	100	-	38	32	3		
PBH 56 - 8M 30	56	5	2012	150,0	142,60	141,23	118	-	38	32	3		
PBH 64 - 8M 30	64	2	2517	168,0	162,97	161,60	140	125,0	38	45	7		
PBH 72 - 8M 30	72	9	2517	192,0	183,35	181,97	158	125,0	38	45	7		
PBH 80 - 8M 30	80	9A	2517	-	203,74	202,35	178	125,0	38	45	7		
PBH 90 - 8M 30	90	9B	2517	-	229,18	227,81	204	120,0	38	45	7		
PBH 112 - 8M 30	112	9B	2517	-	285,21	283,83	260	125,0	38	45	7		
PBH 144 - 8M 30	144	9B	2517	-	366,69	365,32	341	125,0	38	45	7		

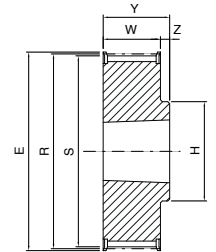

2

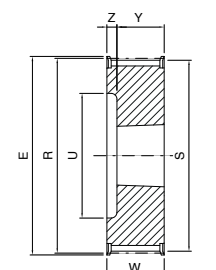

4

## PBH ... -8M50

8M

Codice	N° denti	Tipo	Bussola conica SER-SIT®	E [mm]	R [mm]	S [mm]	U [mm]	H [mm]	W [mm]	Y [mm]	Z [mm]	Flange	Materiale
PBH 28 - 8M 50	28	5	1108	75,0	71,30	70,08	52	-	60	22	19,0	con flange	acciaio
PBH 30 - 8M 50	30	4	1615	83,0	76,39	75,13	58	-	60	38	22,0		
PBH 32 - 8M 50	32	4	1615	87,0	81,49	80,16	60	-	60	38	22,0		
PBH 34 - 8M 50	34	4	1615	91,0	86,58	85,21	66	-	60	38	22,0		
PBH 36 - 8M 50	36	4	1615	97,0	91,67	90,30	68	-	60	38	22,0		
PBH 38 - 8M 50	38	4	1615	102,0	96,77	95,39	75	-	60	38	22,0		
PBH 40 - 8M 50	40	5	2012	106,0	101,86	100,49	80	-	60	32	14,0		
PBH 44 - 8M 50	44	5	2012	120,0	112,05	110,67	90	-	60	32	14,0		
PBH 48 - 8M 50	48	5	2012	128,0	122,23	120,86	100	-	60	32	14,0		
PBH 56 - 8M 50	56	5	2517	150,0	142,60	141,23	120	-	60	45	7,5		
PBH 64 - 8M 50	64	8	2517	168,0	162,97	161,60	138	120,0	60	45	7,5		
PBH 72 - 8M 50	72	8	2517	192,0	183,35	181,97	158	125,0	60	45	7,5		
PBH 80 - 8M 50	80	8A	3020	-	203,74	202,35	178	160,0	60	51	4,5		
PBH 90 - 8M 50	90	8A	3020	-	229,18	227,81	204	160,0	60	51	4,5		
PBH 112 - 8M 50	112	8B	3020	-	285,21	283,83	260	170,0	60	51	4,5		
PBH 144 - 8M 50	144	8B	3020	-	366,69	365,32	341	160,0	60	51	4,5		
PBH 168 - 8M 50	168	8B	3020	-	427,80	426,42	402	160,0	60	51	4,5		
PBH 192 - 8M 50	192	8B	3020	-	488,92	487,54	462	160,0	60	51	4,5		

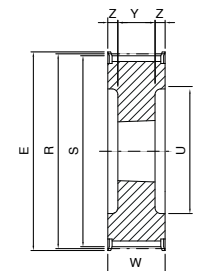

5

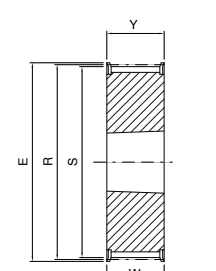

6

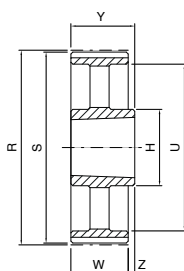

9B

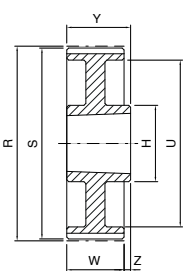

9A

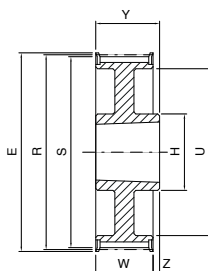

9

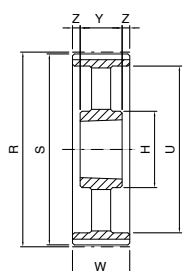

8B

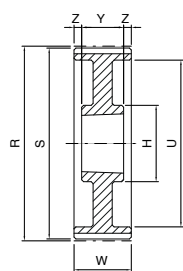

8A

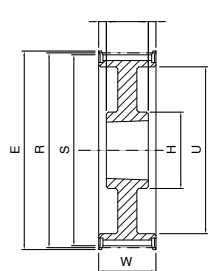

8

# Dimensioni delle pulegge dentate HTD per montaggio con bussola conica SER-SIT®



## PBH ... -8M85

8M

Codice	N° denti	Tipo	Bussola conica SER-SIT®	E [mm]	R [mm]	S [mm]	U [mm]	H [mm]	W [mm]	Y [mm]	Z [mm]	Flange	Materiale
PBH 34 - 8M 85	34	5	1615	91,0	86,58	85,21	66	-	95	38	28,5	con flange	acciaio
PBH 36 - 8M 85	36	5	1615	97,0	91,67	90,30	68	-	95	38	28,5		
PBH 38 - 8M 85	38	5	1615	102,0	96,77	95,39	75	-	95	38	28,5		
PBH 40 - 8M 85	40	5	2012	106,0	101,86	100,49	80	-	95	32	31,5		
PBH 44 - 8M 85	44	5	2012	120,0	112,05	110,67	90	-	95	32	31,5		
PBH 48 - 8M 85	48	5	2517	128,0	122,23	120,86	100	-	95	45	25,0		
PBH 56 - 8M 85	56	5	2517	150,0	142,60	141,23	120	-	95	45	25,0		
PBH 64 - 8M 85	64	5	2517	168,0	162,97	161,60	138	-	95	45	25,0		
PBH 72 - 8M 85	72	5	3020	192,0	183,35	181,97	158	-	95	51	22,0		
PBH 80 - 8M 85	80	8A	3020	-	203,74	202,35	178	160,0	95	51	22,0	senza flange	ghisa
PBH 90 - 8M 85	90	8A	3020	-	229,18	227,81	204	160,0	95	51	22,0		
PBH 112 - 8M 85	112	8B	3020	-	285,21	283,83	260	160,0	95	51	22,0		
PBH 144 - 8M 85	144	8B	3030	-	366,69	365,32	341	140,0	95	76	9,5		
PBH 168 - 8M 85	168	8B	3030	-	427,80	426,42	402	140,0	95	76	9,5		
PBH 192 - 8M 85	192	8B	3030	-	488,92	487,54	462	140,0	95	76	9,5		

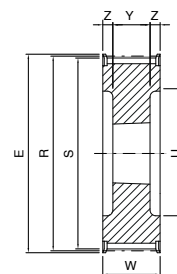

5

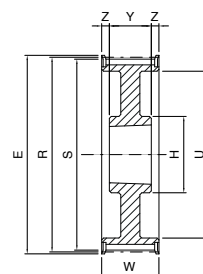

8

## PBH ... -14M40

14M

Codice	N° denti	Tipo	Bussola conica SER-SIT®	E [mm]	R [mm]	S [mm]	U [mm]	H [mm]	W [mm]	Y [mm]	Z [mm]	Flange	Materiale
PBH 28 - 14M 40	28	5	2012	128,0	124,78	122,12	98	-	54	32	11,0	con flange	acciaio
PBH 29 - 14M 40	29	5	2012	138,0	129,23	126,57	100	-	54	32	11,0		
PBH 30 - 14M 40	30	5	2012	138,0	133,69	130,99	100	-	54	32	11,0		
PBH 32 - 14M 40	32	5	2012	154,0	142,60	139,88	104	-	54	32	11,0		
PBH 34 - 14M 40	34	5	2517	160,0	151,52	148,79	110	-	54	45	4,5		
PBH 36 - 14M 40	36	5	2517	168,0	160,43	157,68	120	-	54	45	4,5		
PBH 38 - 14M 40	38	5	2517	183,0	169,34	166,60	130	-	54	45	4,5		
PBH 40 - 14M 40	40	5	2517	188,0	178,25	175,49	138	-	54	45	4,5		
PBH 44 - 14M 40	44	5	3020	211,0	196,08	193,28	154	-	54	51	1,5		
PBH 48 - 14M 40	48	5	3020	226,0	213,90	211,11	172	-	54	51	1,5		
PBH 56 - 14M 40	56	8	3020	256,0	249,56	246,76	207	170,0	54	51	1,5	senza flange	ghisa
PBH 64 - 14M 40	64	8	3020	296,0	285,21	282,41	243	170,0	54	51	1,5		
PBH 72 - 14M 40	72	8A	3020	-	320,86	318,06	279	170,0	54	51	1,5		
PBH 80 - 14M 40	80	8B	3020	-	356,51	353,71	315	170,0	54	51	1,5		
PBH 90 - 14M 40	90	8B	3020	-	401,07	398,28	359	170,0	54	51	1,5		
PBH 112 - 14M 40	112	8B	3020	-	499,11	496,32	457	170,0	54	51	1,5		
PBH 144 - 14M 40	144	8B	3020	-	641,71	638,92	600	170,0	54	51	1,5		
PBH 168 - 14M 40	168	8B	3020	-	748,66	745,87	705	160,0	54	51	1,5		
PBH 192 - 14M 40	192	9B	3535	-	855,62	852,82	812	178,0	54	89	35		
PBH 216 - 14M 40	216	9B	3535	-	962,57	959,77	920	178,0	54	89	35		
PBH 264 - 14M 40	264	9B	3535	-	1176,47	1173,67	1133	178,0	54	89	35		

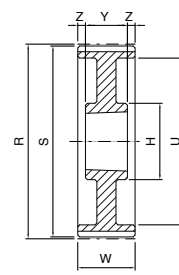

8A

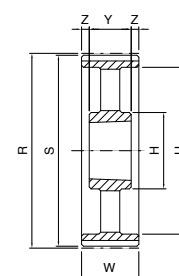

8B

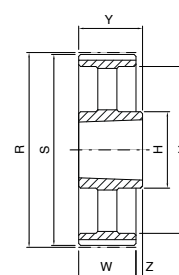

9B

PULEGGE DENTATE

# Dimensioni delle pulegge dentate HTD per montaggio con bussola conica SER-SIT®



## PBH ... -14M55

14M

Codice	N° denti	Tipo	Bussola conica SER-SIT®	E [mm]	R [mm]	S [mm]	U [mm]	H [mm]	W [mm]	Y [mm]	Z [mm]	Flange	Materiale
PBH 28 - 14M 55	28	5	2012	128,0	124,78	122,12	98	-	70	32	19,0	con flange	acciaio
PBH 29 - 14M 55	29	5	2012	138,0	129,23	126,57	100	-	70	32	19,0		
PBH 30 - 14M 55	30	5	2517	138,0	133,69	130,99	100	-	70	45	12,5		
PBH 32 - 14M 55	32	5	2517	154,0	142,60	139,88	104	-	70	45	12,5		
PBH 34 - 14M 55	34	5	2517	160,0	151,52	148,79	110	-	70	45	12,5		
PBH 36 - 14M 55	36	5	2517	168,0	160,43	157,68	120	-	70	45	12,5		
PBH 38 - 14M 55	38	5	2517	183,0	169,34	166,60	130	-	70	45	12,5		
PBH 40 - 14M 55	40	5	2517	188,0	178,25	175,49	138	-	70	45	12,5		
PBH 44 - 14M 55	44	5	3020	211,0	196,08	193,28	154	-	70	51	9,5		
PBH 48 - 14M 55	48	5	3020	226,0	213,90	211,11	172	-	70	51	9,5		
PBH 56 - 14M 55	56	8	3020	256,0	249,56	246,76	207	170,0	70	51	9,5		
PBH 64 - 14M 55	64	8	3020	296,0	285,21	282,41	243	170,0	70	51	9,5		
PBH 72 - 14M 55	72	8A	3020	-	320,86	318,06	279	170,0	70	51	9,5		
PBH 80 - 14M 55	80	8B	3020	-	356,51	353,71	314	170,0	70	51	9,5		
PBH 90 - 14M 55	90	8B	3020	-	401,07	398,28	359	170,0	70	51	9,5		
PBH 112 - 14M 55	112	8B	3020	-	499,11	496,32	457	170,0	70	51	9,5		
PBH 144 - 14M 55	144	8B	3020	-	641,71	638,92	600	170,0	70	51	9,5		
PBH 168 - 14M 55	168	8B	3020	-	748,66	745,87	705	160,0	70	51	9,5		
PBH 192 - 14M 55	192	9B	3535	-	855,62	852,82	812	178,0	70	89	19,0		
PBH 216 - 14M 55	216	9B	3535	-	962,57	959,77	920	178,0	70	89	19,0		
PBH 264 - 14M 55	264	9B	3535	-	1176,47	1173,67	1133	178,0	70	89	19,0		

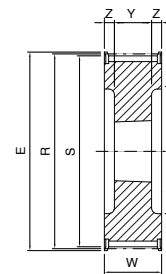

5

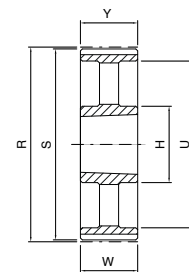

7B

## PBH ... -14M85

14M

Codice	N° denti	Tipo	Bussola conica SER-SIT®	E [mm]	R [mm]	S [mm]	U [mm]	H [mm]	W [mm]	Y [mm]	Z [mm]	Flange	Materiale
PBH 28 - 14M 85	28	5	2517	128,0	124,78	122,12	98	-	102	45	28,5	con flange	acciaio
PBH 29 - 14M 85	29	5	2517	138,0	129,23	126,57	100	-	102	45	28,5		
PBH 30 - 14M 85	30	5	2517	138,0	133,69	130,99	100	-	102	45	28,5		
PBH 32 - 14M 85	32	5	2517	154,0	142,60	139,88	104	-	102	45	28,5		
PBH 34 - 14M 85	34	5	2517	160,0	151,52	148,79	110	-	102	45	28,5		
PBH 36 - 14M 85	36	5	3020	168,0	160,43	157,68	120	-	102	51	25,5		
PBH 38 - 14M 85	38	5	3020	183,0	169,34	166,60	130	-	102	51	25,5		
PBH 40 - 14M 85	40	5	3020	188,0	178,25	175,49	138	-	102	51	25,5		
PBH 44 - 14M 85	44	5	3030	211,0	196,08	193,28	154	-	102	76	13,0		
PBH 48 - 14M 85	48	5	3030	226,0	213,90	211,11	172	-	102	76	13,0		
PBH 56 - 14M 85	56	5	3535	256,0	249,56	246,76	207	-	102	89	6,5		
PBH 64 - 14M 85	64	8	3535	296,0	285,21	282,41	243	178,0	102	89	6,5		
PBH 72 - 14M 85	72	8A	3535	-	320,86	318,06	279	178,0	102	89	6,5		
PBH 80 - 14M 85	80	8B	3535	-	356,51	353,71	314	190,0	102	89	6,5		
PBH 90 - 14M 85	90	8B	3535	-	401,07	398,28	359	190,0	102	89	6,5		
PBH 112 - 14M 85	112	8B	3535	-	499,11	496,32	457	178,0	102	89	6,5		
PBH 144 - 14M 85	144	8B	3535	-	641,71	638,92	600	190,0	102	89	6,5		
PBH 168 - 14M 85	168	8B	3535	-	748,66	745,87	705	178,0	102	89	6,5		
PBH 192 - 14M 85	192	7B	4040	-	855,62	852,82	812	215,0	102	102	-		
PBH 216 - 14M 85	216	7B	4040	-	962,57	959,77	920	215,0	102	102	-		
PBH 264 - 14M 85	264	7B	4040	-	1176,47	1173,67	1133	215,0	102	102	-		

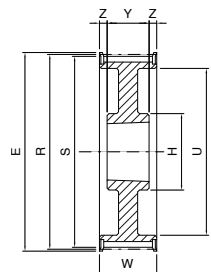

8

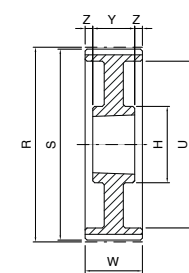

8A

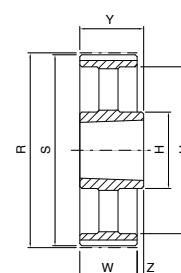

9B

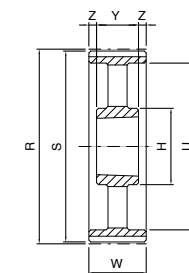

8B

# Dimensioni delle pulegge dentate HTD per montaggio con bussola conica SER-SIT®



## PBH ... -14M115

14M

Codice	N° denti	Tipo	Bussola conica SER-SIT®	E [mm]	R [mm]	S [mm]	U [mm]	H [mm]	W [mm]	Y [mm]	Z [mm]	Flange	Materiale
PBH 28 - 14M 115	28	5	2517	128,0	124,78	122,12	98	-	133	45	44,0	con flange	acciaio
PBH 29 - 14M 115	29	5	2517	138,0	129,23	126,57	100	-	133	45	44,0		
PBH 30 - 14M 115	30	5	2517	138,0	133,69	130,99	100	-	133	45	44,0		
PBH 32 - 14M 115	32	5	2517	154,0	142,60	139,88	104	-	133	45	44,0		
PBH 34 - 14M 115	34	5	2517	160,0	151,52	148,79	110	-	133	45	44,0		
PBH 36 - 14M 115	36	5	3020	168,0	160,43	157,68	120	-	133	51	41,0		
PBH 38 - 14M 115	38	5	3020	183,0	169,34	166,60	130	-	133	51	41,0		
PBH 40 - 14M 115	40	5	3020	188,0	178,25	175,49	138	-	133	51	41,0		
PBH 44 - 14M 115	44	5	3030	211,0	196,08	193,28	154	-	133	76	28,5		
PBH 48 - 14M 115	48	5	3030	226,0	213,90	211,11	172	-	133	76	28,5		
PBH 56 - 14M 115	56	5	3535	256,0	249,56	246,76	207	-	133	89	22,0		
PBH 64 - 14M 115	64	8	3535	296,0	285,21	282,41	243	178,0	133	89	22,0		
PBH 72 - 14M 115	72	8A	3535	-	320,86	318,06	279	178,0	133	89	22,0		
PBH 80 - 14M 115	80	8B	3535	-	356,51	353,71	314	178,0	133	89	22,0		
PBH 90 - 14M 115	90	8B	3535	-	401,07	398,28	359	178,0	133	89	22,0		
PBH 112 - 14M 115	112	8B	3535	-	499,11	496,32	457	178,0	133	89	22,0		
PBH 144 - 14M 115	144	8B	4040	-	641,71	638,92	600	230,0	133	102	15,5		
PBH 168 - 14M 115	168	8B	4040	-	748,66	745,87	705	215,0	133	102	15,5		
PBH 192 - 14M 115	192	8B	4040	-	855,62	852,82	812	215,0	133	102	15,5		
PBH 216 - 14M 115	216	8B	4040	-	962,57	959,77	920	215,0	133	102	15,5		
PBH 264 - 14M 115	264	8B	5050	-	1176,47	1173,67	1133	267,0	133	127	3,0		

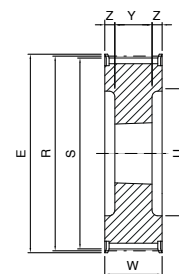

5

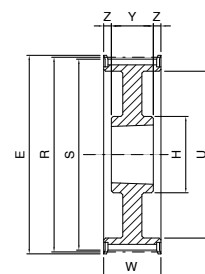

8

## PBH ... -14M170

14M

Codice	N° denti	Tipo	Bussola conica SER-SIT®	E [mm]	R [mm]	S [mm]	U [mm]	H [mm]	W [mm]	Y [mm]	Z [mm]	Flange	Materiale
PBH 38 - 14M 170	38	5	3030	183,0	169,34	166,60	130	-	187	76	55,5	con flange	acciaio
PBH 40 - 14M 170	40	5	3030	188,0	178,25	175,49	138	-	187	76	55,5		
PBH 44 - 14M 170	44	5	3535	211,0	196,08	193,28	154	-	187	89	49,0		
PBH 48 - 14M 170	48	5	3535	226,0	213,90	211,11	172	-	187	89	49,0		
PBH 56 - 14M 170	56	5	3535	256,0	249,56	246,76	207	-	187	89	49,0		
PBH 64 - 14M 170	64	5	4040	296,0	285,21	282,41	243	-	187	102	42,5		
PBH 72 - 14M 170	72	8A	4040	-	320,86	318,06	280	230,0	187	102	42,5		
PBH 80 - 14M 170	80	8A	4040	-	356,51	353,71	314	230,0	187	102	42,5		
PBH 90 - 14M 170	90	8B	4040	-	401,07	398,28	359	230,0	187	102	42,5		
PBH 112 - 14M 170	112	8B	5050	-	499,11	496,32	457	265,0	187	127	30,0		
PBH 144 - 14M 170	144	8B	5050	-	641,71	638,92	600	265,0	187	127	30,0		
PBH 168 - 14M 170	168	8B	5050	-	748,66	745,87	705	267,0	187	127	30,0		
PBH 192 - 14M 170	192	8B	5050	-	855,62	852,82	812	267,0	187	127	30,0		
PBH 216 - 14M 170	216	8B	5050	-	962,57	959,77	920	267,0	187	127	30,0		
PBH 264 - 14M 170	264	8B	5050	-	1176,47	1173,67	1133	267,0	187	127	30,0		

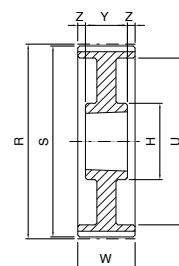

8A

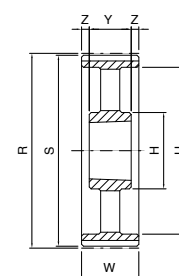

8B

PULEGGE DENTATE

## Barre dentate - HTD

### Passi 3M - 5M - 8M

Le barre HTD sono costruite in alluminio 6082 adatto per l'ossidazione dura a spessore.

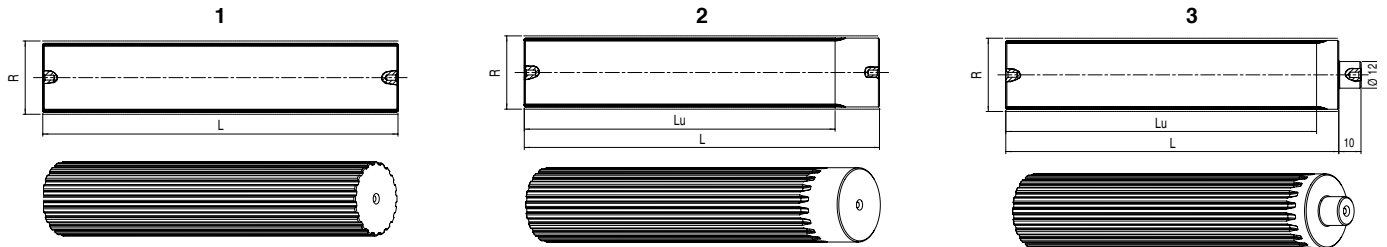

HTD 3M passo 3 mm					
ALLUMINIO					
Codice	N° denti	Tipo	R [mm]	Lu [mm]	L [mm]
BAR9-3M*	9	3	8,59	75	100
BAR10-3M	10	3	9,55	75	100
BAR11-3M*	11	3	10,50	75	100
BAR12-3M	12	3	11,46	100	125
BAR13-3M*	13	3	12,41	100	125
BAR14-3M	14	3	13,37	100	125
BAR15-3M	15	3	14,32	100	125
BAR16-3M	16	3	15,28	125	155
BAR17-3M*	17	3	16,23	125	155
BAR18-3M	18	3	17,19	125	155
BAR19-3M*	19	3	18,14	125	155
BAR20-3M	20	3	19,10	150	165
BAR21-3M	21	3	20,05	150	165
BAR22-3M	22	3	21,01	150	165
BAR23-3M*	23	3	21,96	150	165
BAR24-3M	24	3	22,92	150	165
BAR25-3M*	25	3	23,87	150	165
BAR26-3M	26	3	24,83	150	165
BAR27-3M*	27	3	25,78	150	165
BAR28-3M	28	3	26,74	150	165
BAR29-3M*	29	3	27,69	150	165
BAR30-3M	30	3	28,65	175	183
BAR31-3M*	31	3	29,60	175	183
BAR32-3M	32	3	30,56	175	183
BAR33-3M*	33	3	31,51	175	183
BAR34-3M	34	3	32,47	175	183
BAR35-3M*	35	3	33,42	175	183
BAR36-3M	36	3	34,38	200	200
BAR37-3M*	37	3	35,33	200	200
BAR38-3M	38	3	36,29	200	200
BAR39-3M*	39	3	37,24	200	200
BAR40-3M	40	3	38,20	200	200
BAR42-3M*	42	3	40,11	200	200
BAR44-3M	44	3	42,02	200	200
BAR45-3M*	45	3	42,97	200	200
BAR48-3M	48	3	45,84	200	200
BAR50-3M*	50	3	47,75	200	200
BAR52-3M*	52	3	49,66	200	200
BAR54-3M*	54	3	51,57	200	200
BAR56-3M*	56	3	53,48	200	200
BAR60-3M	60	3	57,30	200	200
BAR62-3M*	62	3	59,21	200	200
BAR64-3M*	64	3	61,12	200	200
BAR66-3M*	66	3	63,03	200	200
BAR68-3M*	68	3	64,94	200	200
BAR70-3M*	70	3	66,85	200	200
BAR72-3M*	72	3	68,75	200	200

HTD 5M passo 5 mm					
ALLUMINIO					
Codice	N° denti	Tipo	R [mm]	Lu [mm]	L [mm]
BAR12-5M	12	2	19,10	150	165
BAR13-5M	13	2	20,69	150	165
BAR14-5M	14	2	22,28	175	183
BAR15-5M	15	2	23,87	175	183
BAR16-5M	16	2	25,46	175	183
BAR17-5M	17	2	27,06	175	183
BAR18-5M	18	1	28,65	200	200
BAR19-5M	19	1	30,24	200	200
BAR20-5M	20	1	31,83	200	200
BAR21-5M	21	1	33,42	200	200
BAR22-5M	22	1	35,01	200	200
BAR23-5M	23	1	36,61	200	200
BAR24-5M	24	1	38,20	200	200
BAR25-5M	25	1	39,79	200	200
BAR26-5M	26	1	41,38	200	200
BAR27-5M	27	1	42,97	200	200
BAR28-5M	28	1	44,56	200	200
BAR29-5M	29	1	46,15	200	200
BAR30-5M	30	1	47,75	200	200
BAR31-5M	31	1	49,34	200	200
BAR32-5M	32	1	50,93	200	200
BAR33-5M	33	1	52,52	200	200
BAR34-5M	34	1	54,11	200	200
BAR35-5M	35	1	55,70	200	200
BAR36-5M	36	1	57,30	200	200
BAR38-5M	38	1	60,48	200	200
BAR40-5M	40	1	63,66	200	200
BAR42-5M	42	1	66,85	200	200
BAR44-5M	44	1	70,03	200	200
BAR45-5M	45	1	71,62	200	200
BAR46-5M	46	1	73,21	200	200
BAR48-5M	48	1	76,39	200	200
BAR50-5M	50	1	79,58	200	200
BAR54-5M	54	1	85,94	200	200
BAR60-5M	60	1	95,49	200	200
BAR62-5M	62	1	98,68	200	200
BAR72-5M	72	1	114,59	200	200

HTD 8M passo 8 mm					
ALLUMINIO					
Codice	N° denti	Tipo	R [mm]	Lu [mm]	L [mm]
BAR18-8M	18	1	45,84	200	200
BAR19-8M	19	1	48,38	200	200
BAR20-8M	20	1	50,93	200	200
BAR21-8M	21	1	53,48	200	200
BAR22-8M	22	1	56,02	200	200
BAR23-8M	23	1	58,57	200	200
BAR24-8M	24	1	61,12	200	200
BAR25-8M	25	1	63,66	200	200
BAR26-8M	26	1	66,21	200	200
BAR28-8M	28	1	71,30	200	200
BAR30-8M	30	1	76,39	200	200
BAR32-8M	32	1	81,49	200	200
BAR34-8M	34	1	86,58	200	200
BAR35-8M	35	1	89,13	200	200
BAR36-8M	36	1	91,67	200	200
BAR38-8M	38	1	96,77	200	200
BAR40-8M	40	1	101,86	200	200
BAR44-8M	44	1	112,05	200	200
BAR48-8M	48	1	122,23	200	200

\*= disponibile a richiesta

Esempio di codifica **BAR 25 -5M /AL**

Barra dentata HTD

Numero denti

Passo

Materiale - AL: alluminio